



JIEJIE MICROELECTRONICS CO., LTD.

JR0105V 1A SCR

JR0105V

 **JieJie Microelectronics Co., Ltd.**

ORDERING INFORMATION

J R 01 05 V

FIG.1: 

RMS □ -b □

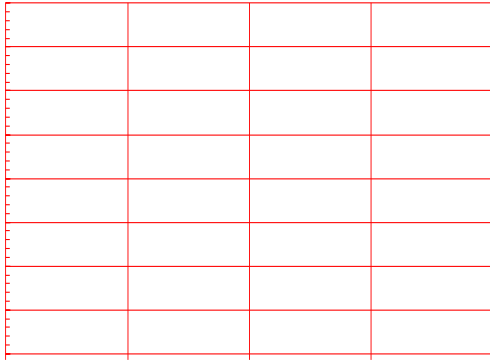
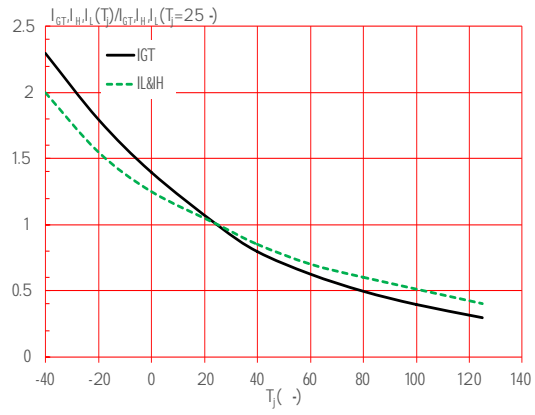

FIG.2: RMS □ -~~time~~

□

FIG.7: $I_{GT}/I_{GT}(T)/I_{GT}(T=25^\circ C)$
 $I_{L&H}/I_{L&H}(T)/I_{L&H}(T=25^\circ C)$



ORDERING INFORMATION

Order code	Voltage V _{DRM} /V _{R_{RRM}} (V)	IGT \$	Package	Base qty. (pcs)	Delivery mode
JR0105V	600	'200	SOT-223	4000	Tape & Reel

Document Revision History

Date	Rev	Change
Apr.10, 2023	A.1.0	Initial
Oct. 23, 2025	A.1.1	REWORK PACKAGE MECHAN I CALL

PACKAGE MECHANICAL DATA

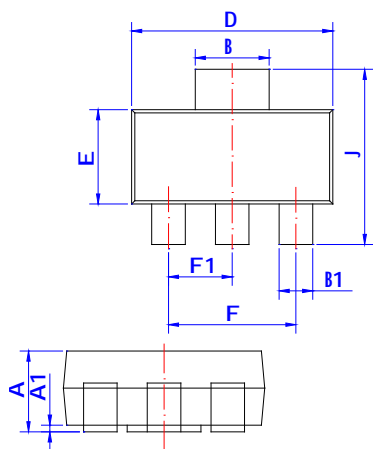

RE	Dim					
	In			In		
	In	Typ	Max	In	Typ	Max
A	1.50	1.60	1.80	0.059	0.063	0.071
A1	0.01	0.06	0.10	0.001	0.002	0.004
B	2.90	3.00	3.10	0.114	0.118	0.122
B1	0.60	0.70	0.80	0.024	0.028	0.031
C	0.22	0.26	0.32	0.009	0.010	0.013
D	6.30	6.50	6.70	0.248	0.256	0.264
E	3.30	3.50	3.70	0.130	0.138	0.146
F	4.40		4.80	0.173		0.189
F1	2.20		2.40	0.087		0.094
G	0.50		1.00	0.020		0.039
H	1.50	1.75	2.00	0.059	0.069	0.079
J	6.70	7.00	7.30	0.264	0.276	0.287
K	0.80		1.00	0.031		0.039

DELIVERY MODE

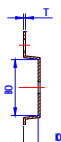
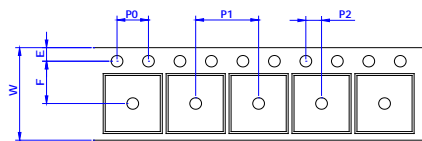

Ré	Dim					
	In			Is		
	In	Typ	Max	In	Typ	Max
W	-		12.30	-		0.482
E	1.65	1.75	1.85	0.065	0.069	0.073
F	5.45	5.50	5.55	0.215	0.217	0.219
D0		1.55	1.60		0.061	0.063
D1		-	-			
P0	3.90	4.00	4.10	0.154	0.157	0.161
P1	7.90	8.00	8.10	0.311	0.315	0.319
P2	1.95	2.00	2.05	0.077	0.079	0.081
10P0	39.80	40.00	40.20	1.567	1.575	1.583
A0	6.85	6.95	7.05	0.269	0.273	0.276
B0	7.15	7.25	7.35	0.280	0.284	0.288
D	1.95	2.05	2.15	0.076	0.080	0.084
T	0.20	0.25	0.30	0.008	0.010	0.012

江界微电子
江界微电子

江界